

MANUAL RESET BUTTON
(MODELS PM1411 & PM1411V ONLY)

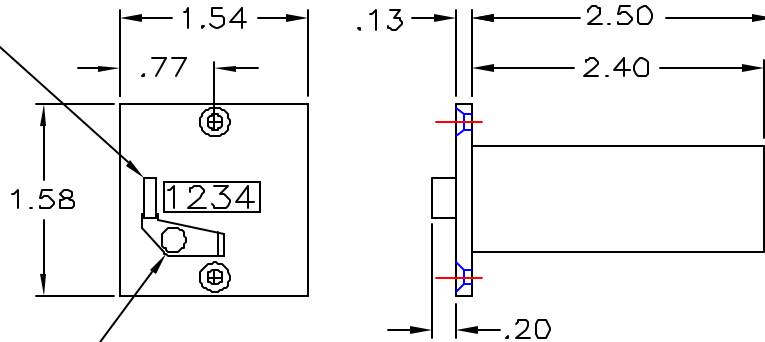

RESET GUARD
(MODEL PM1411V ONLY)

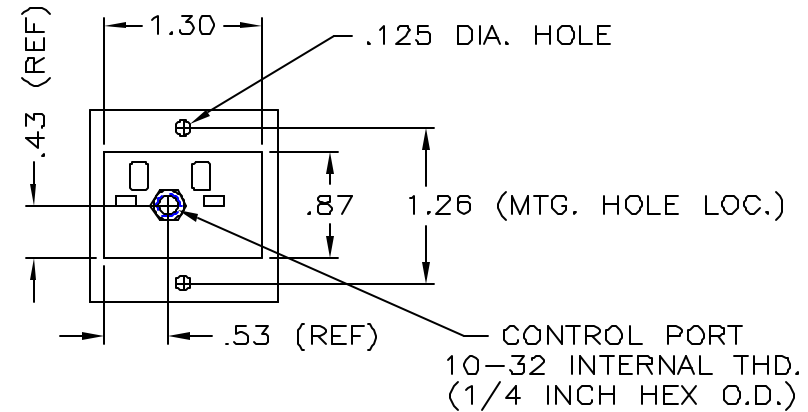

CAUTION: DO NOT OVER TIGHTEN
DURING ASSEMBLY OF
MATING FITTING.

TECHNICAL DATA:

OPERATING PRESSURE RANGE - 25 TO 100 PSI
 MAXIMUM COUNT SPEED - 10 CPS (CYCLES PER SECOND)
 OPERATING TEMPERATURE RANGE - 32°F TO 140°F
 WEIGHT - 2.5 OUNCES
 COLOR - CASE (BLACK), LETTERS (WHITE)
 DIGIT SIZE - .16 INCH (4mm)
 DUTY CYCLE - CONTINUOUS (MIN. PULSE DURATION 8ms)
 (MIN PAUSE DURATION 10ms)
 MEDIA - FILTERED AIR OR NONAGGRESSIVE GAS NON-LUBRICATED

NOTE: 1 - PRESSURE MUST DROP TO 4.4 PSI MAX. BETWEEN PULSES
 2 - DO NOT LUBRICATE (DEVICE IS SELF LUBRICATING)

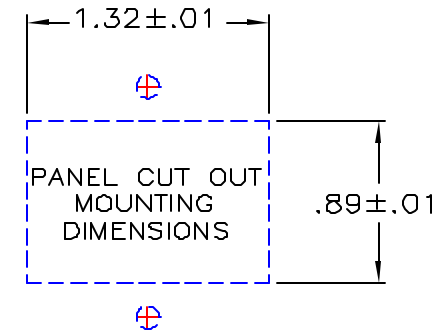

HOW TO ORDER: AVAILABLE IN THE FOLLOWING MODELS

PM1410 = NON-RESET MODEL
 PM1411 = MANUAL PUSH BUTTON RESET
 PM1411V = P.B. RESET WITH RESET GUARD

ELLIS/KUHNKE CONTROLS

DRAWN BY EJJ		4 - DIGIT PM COUNTER PANELMOUNT VERSION	
CHECKED		SIZE B	DWG. NO. PM141*
ISSUED		FSC# N3	SHEET
		SCALE 4:1	