

OPERATING PRESSURE RANGE - 25 TO 100 PSI
 MAXIMUM COUNT SPEED - 10 CPS (CYCLES PER SECOND)
 OPERATING TEMPERATURE RANGE - 32°F TO 140°F
 WEIGHT - 3.6 OUNCES
 COLOR - CASE (BLACK), NUMBERS (WHITE)
 DUTY CYCLE - CONTINUOUS (MIN. PULSE DURATION 8MS)
 (MIN. PAUSE DURATION 10ms)
 MEDIA - FILTERED AIR OR NONAGGRESSIVE GAS
 NON-LUBRICATED

NOTE: CONTROL PRESSURE MUST DROP TO 4.4 PSI MAX. BETWEEN PULSES..

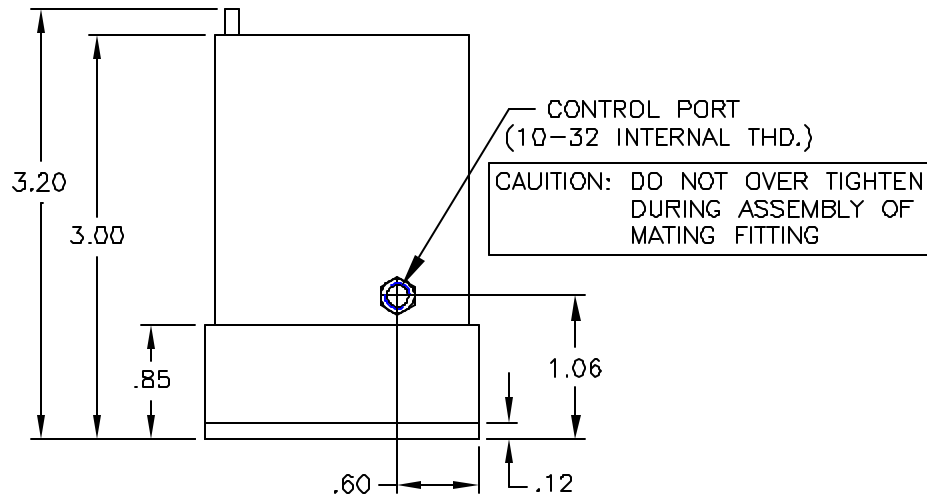
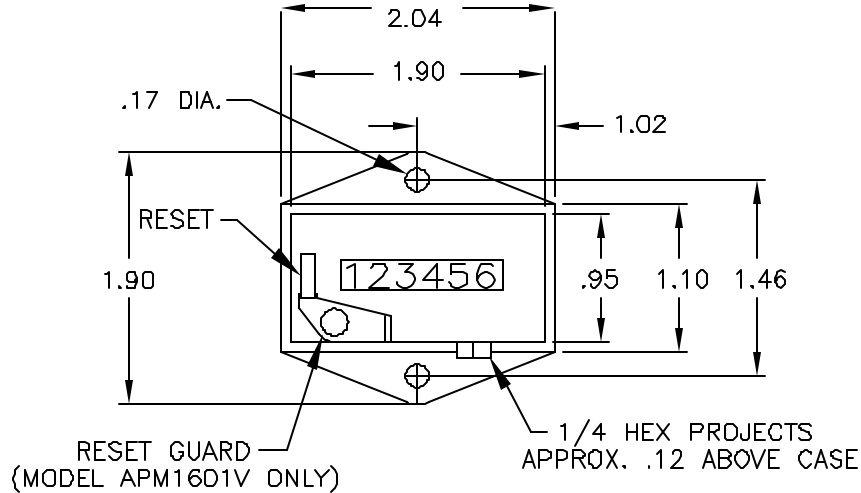

HOW TO ORDER: AVAILABLE IN THE FOLLOWING MODELS

APM1600 = NON-RESET MODEL

APM1601 = MANUAL PUSH BUTTON RESET

APM1601V = MANUAL PUSH BUTTON RESET WITH GUARD

		ELLIS/KUHNKE CONTROLS			
		DRAWN BY	EJL	8/14/02	6 - DIGIT APM COUNTER BASE MOUNT VERSION
MATERIAL		CHECKED			
FINISH		ISSUED		SIZE	FSCM NO.
DO NOT SCALE DRAWING				DWG. NO.	APM160*
				SCALE	.70
				SHEET	1 OF 1